

STAINLESS STEEL 304 PRESS FIT FITTINGS (M PROFILE)

COMPLY WITH BSEN1254-2: 1998
AS 3688: 2005
AS/NZS 4020: 2005
SS 375: 2015
SS 270: 2015

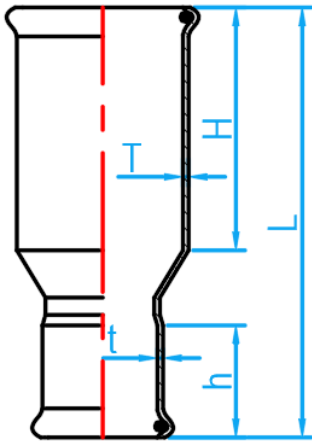

REDUCEING SOCKET



CROSS SECTIONAL VIEW

DIMENSIONS

SKU	SIZE (mm)	L (mm)	H (mm)	h (mm)	T (mm)	t (mm)	WEIGHT (kg)	PCS/CT N
SSPFNRS02015	22×15	61	21	20	1.5	1.5	0.054	200
SSPFNRS02515	28×15	65	23	20	1.5	1.5	0.068	160
SSPFNRS02520	28×22	65	23	21	1.5	1.5	0.075	130
SSPFNRS03515	35×15	70	26	20	1.5	1.5	0.087	160
SSPFNRS03520	35×22	70	26	21	1.5	1.5	0.083	120
SSPFNRS03525	35×28	68	26	23	1.5	1.5	0.097	80
SSPFNRS04215	42×15	78	31	20	1.5	1.5	0.110	120
SSPFNRS04220	42×22	76	31	21	1.5	1.5	0.122	130
SSPFNRS04225	42×28	76	31	23	1.5	1.5	0.125	100
SSPFNRS04235	42×35	77	31	26	1.5	1.5	0.133	70
SSPFNRS05015	54×15	90	36	20	1.5	1.5	0.166	70
SSPFNRS05020	54×22	186	36	21	1.5	1.5	0.162	70
SSPFNRS05025	54×28	90	36	23	1.5	1.5	0.175	100
SSPFNRS05035	54×35	88	36	26	1.5	1.5	0.180	70
SSPFNRS05042	54×42	94	36	31	1.5	1.5	0.207	70
SSPFNRS06525	67×28	114	50	23	2.0	1.5	0.320	25
SSPFNRS06535	67×35	115	50	26	2.0	1.5	0.322	25
SSPFNRS06542	67×42	117	50	31	2.0	1.5	0.338	25
SSPFNRS06550	67×54	119	50	36	2.0	1.5	0.347	36
SSPFNRS08025	76×28	126	51	23	2.0	1.5	0.420	20
SSPFNRS08035	76×35	130	51	26	2.0	1.5	0.425	20
SSPFNRS08042	76×42	135	51	31	2.0	1.5	0.435	20
SSPFNRS08050	76×54	129	51	36	2.0	1.5	0.454	36
SSPFNRS08065	76×67	141	51	50	2.0	2.0	0.590	20
SSPFNRS10042	108×42	158	75	31	2.0	1.5	0.790	12
SSPFNRS10050	108×54	162	75	36	2.0	1.5	0.810	12
SSPFNRS10065	108×67	178	75	50	2.0	2.0	0.905	12
SSPFNRS10080	108×76	178	75	51	2.0	2.0	0.942	12